

DiaSafe® Wall-fix

Fall Protection Anchoring System
130905 / 130906 / 130907



ADVANTAGES

- Can be combined with DiaSafe® systems
- Multi-user, even without unhooking¹
- 3 types of system are available : Single • Line Multi • Glide
- Space-saving - no attachment with a ballast, therefore no damping mat
- Can be used in both the compressed and drawn zones of concrete
- Smoke resistant stainless steel design

* in case of Glide

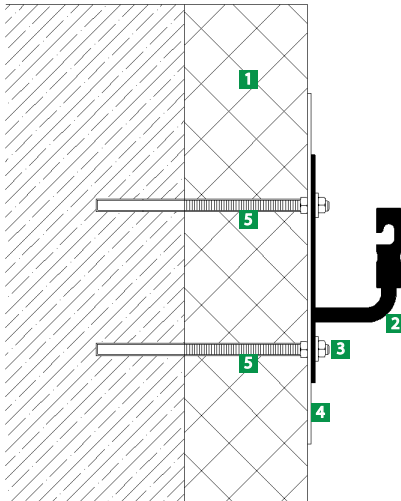

DIADEM® BUILD-UP

1. Thermal insulation
2. DiaSafe® Wall-fix
3. Base screw* + Self locking nut
4. Washer**
5. Spacer Tube**



* Not part of the product

** Additional element. Only needed if the wall is insulated, for load distribution.

APPLICATION

Wall-fix Systems are primarily made to be mechanically fixed to wall structures with adequate load bearing capacity for securing people working at heights. The system can be used as fall restraint or fall arrest system as well.



0408



CEN/TS 16415

SPECIFICATION

CE-marked safety system against falls from height, fixed mechanically to building structure with adequate load bearing capacity (which resists adynamic force of 15kN), for use by 1+1 persons or-incertaincombination -for use by several persons according to the standards EN 795:2012 and CEN/TS 16415:2013, class „A“ and „C“ certified as fall arrest or fall restraint system. With system components made of 1.4404 (316) stainless steel, resistant to acid environments and salt air in coastal regions with control label and detailed documentation. Supplied fully functional, ready for immediate professional installation according to the approved installation plan and the guidelines provided by the manufacturer. The fasteners necessary for the installation are not included.

Product: DiaSafe® Wall-fix
Producer's certificate: A.P.P. Kft.
Website: www.diadem.com

TECHNICAL DATA

Maximum inclination of roof:	45°
Maximum number of users:	2
Wall anchors minimum distance [m]:	1.5
Wall anchors maximum distance [m]:	8
Tensile strength of cable [kN]:	33.4
Maximum static load of the system during a rescue process according to EN 795:2012 [kg]:	600
Material:	1.4404 (316) stainless steel

DiaSafe® Wall-fix
Single



DiaSafe® Wall-fix
Glide



DiaSafe® Wall-fix
Line Multi



A.P.P. Kft.

Tel.: +36 96 512 910 • info@diadem.com • www.diadem.com/hu

APP Dachgarten GmbH

Tel.: +49 841 370 9496 • info@diadem.com • www.diadem.com/de

DIADEM CH AG.

Tel.: +41 79 516 20 62 • info@diadem.com • www.diadem.com

